

FED-26831-A67

SHT 1.1

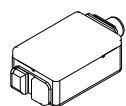
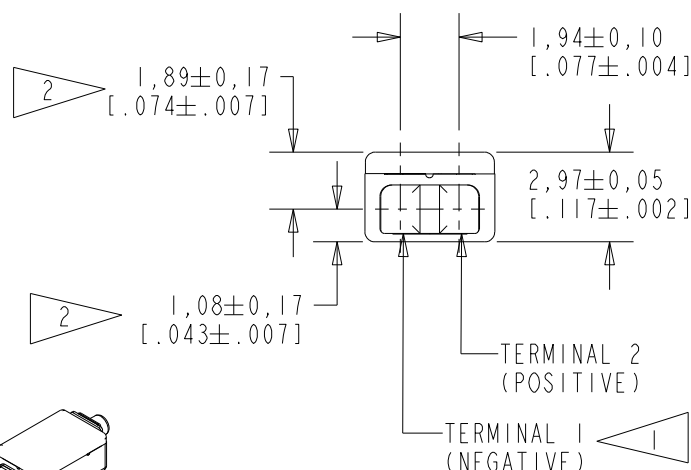
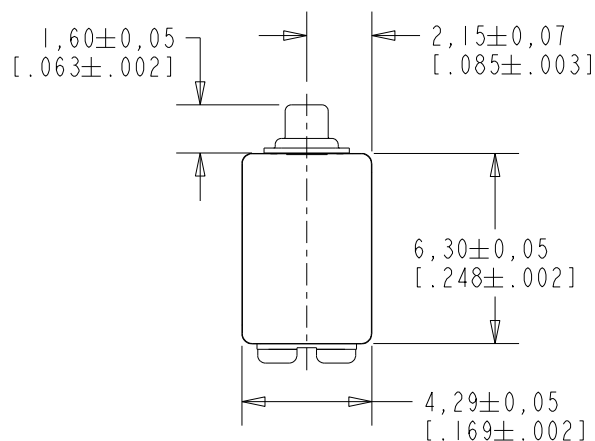

SCALE 2:1

NOMINAL WEIGHT  
.31 GRAMS

DIMENSIONS IN MILLIMETERS [INCHES]

NOTE:

- 1 A POSITIVE GOING VOLTAGE AT TERMINAL 2, RELATIVE TO TERMINAL 1, CAUSES A DECREASE IN PRESSURE AT THE SOUND OUTLET.
- 2 LOCATED FROM TWO SURFACES FOR CUSTOMER CONVENIENCE. ONLY APPLICABLE FROM ONE SURFACE, NOT TO BE USED TOGETHER. HORIZONTAL LOCATION FOR TERMINAL CENTERED TO  $\pm 0,17$  [ $.007$ ].

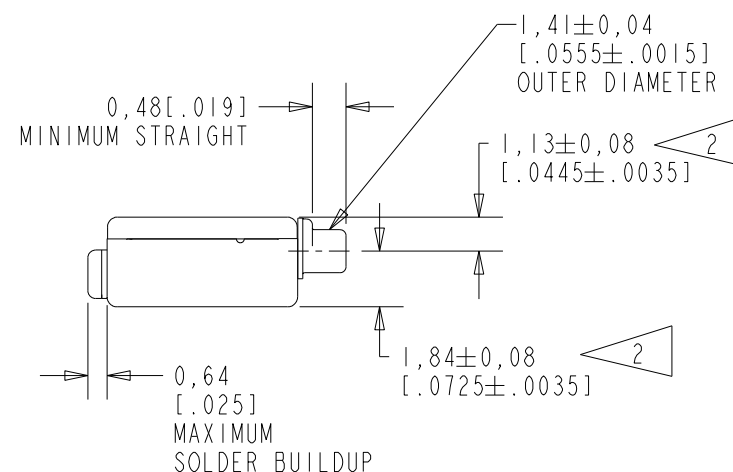

Revision	C.O. #	Implementation Date	RELEASE LEVEL	REVISION
			Active	D
D	PI0000687	8-15-16		
SCALE: 4:1			DR. BY	DATE
DO NOT SCALE DRAWING			CRG	2-2-06
			CK. BY	DATE
TITLE: RECEIVER		FED-26831-A67	GJP	2-8-06
			APP. BY	DATE
OUTLINE DRAWING		SHT 1.1	GJP	2-8-06

KNOWLES CORPORATION

FERROFLUID AND TYPE III DAMPING	FED-26831-A67 SHEET 2.1
------------------------------------	----------------------------



PORT LOCATION: 12C

TABLE I

FREQUENCY (Hz)	AC DRIVE (V rms)	DC BIAS (mA)	LIMIT (%)
500	0.792	0	10
830	0.281	0	5
1250	0.281	0	5

TABLE 2

## TEST CONDITIONS

NOMINAL SOURCE VOLTAGE	0.281 V rms, 0mA DC BIAS
SOURCE IMPEDANCE	<1 Ohm
TUBING	10mm [.394"] LONG, 1mm [.039"] I.D.
COUPLER CAVITY	2 CM <sup>3</sup> , SIMULATED ANSI S3.7 TYPE HA-3 (IEC 60318-5)

TABLE 3

## ELECTRICAL

DC RESISTANCE	91 OHMS $\pm$ 10%
IMPEDANCE @ 500 Hz	173 OHMS $\pm$ 15%
IMPEDANCE @ 1 kHz	294 OHMS $\pm$ 15%

TABLE 4

ISOLATION: CASE WILL BE ELECTRICALLY ISOLATED FROM THE COIL CIRCUIT.

TEMPERATURE: OPERATING RANGE FROM 0°C TO 63°C (SENSITIVITY WILL NOT VARY BY MORE THAN  $\pm 3$  dB WITHIN RANGE)  
SENSITIVITY AT 0°C IS 2dB LOWER THAN THE SENSITIVITY AT ROOM TEMPERATURE.  
DELTA PEAK IS 1dB HIGHER AT BODY TEMPERATURE (37°C)  
STORAGE RANGE FROM -40°C TO 63°C.

Revision	C.O. #	Implementation Date	RELEASE LEVEL	REVISION
			Active	D
D	PI0000687	8-15-16		
WHEN TEST LIMITS ARE USED TO ESTABLISH INCOMING INSPECTION ACCEPTANCE/REJECTION CRITERIA, CORRELATION OF TEST EQUIPMENT WITH KNOWLES IS ALSO REQUIRED FOR ELIMINATION OF EQUIPMENT AND TEST METHOD VARIATION			DR. BY	DATE
			CRG	2-2-06
			CK. BY	DATE
			GJP	2-8-06
			APP. BY	DATE
			GJP	2-8-06

# KNOWLES CORPORATION